

Shire Amateur Photographers' Society

'Our aim is not to compete against each other – rather, to learn from each other'

Greg Ford 0415 412 244 (9528 3475)

Website: www.sutherlandshirephotography.com.au

Email: gphoto@optusnet.com.au



S.A.P.S. (Shire Amateur Photographers' Society)
<https://www.flickr.com/groups/saps/pool/>



Shire Amateur Photographers' Society (SAPS)
<https://www.facebook.com/groups/shireAmateur/>

BLACKBOARD of Outings & Events

<https://www.sutherlandshirephotography.com.au/blackboard/>

UPDATE No. 183 (26/10/17)

Hi everybody,

Firstly, Optus had a hiccup with me sending out the last Newsletter on the 14th October. It was 11 pages (No. 182). If you did not receive it, please let me know, and I will send it A.S.A.P. Greg

Whether you have already been to Sculpture by the Sea, or are going with us on Saturday, please send me 5 images of your outing to this event by 'WeTransfer' (*PDF instructions end of this UPDATE*) by Tuesday 31st October, so we can view at the next Society meeting, on the 2nd November, thank you.

'Sculpture by the Sea' Outing

This Saturday 28th October

(weather forecast is GOOD at the moment ...)

Meeting at Jannali High School at **4.15am** (car-pooling) or

Meeting at Marks Park, Bondi at **5.15am**

If you message me a day or two before, to tell me you are interested in going, I will message you, if I decide to cancel due to the weather (*there is no other cancellation notification option available*)

If it needs to be cancelled then it will be rescheduled to Tuesday 31st October (same times – same place)

The Day: Arrive at Marks Park just before dawn. Access sculptures at Marks Park then start taking silhouette images as the morning sunrise back-lights the sculptures. After sunrise, walk along coastal walk to Bondi Icebergs capturing the sculptures dotted along this walk, then return past Marks Park continuing along the coastal walk to Tamarama Beach, before grabbing a coffee, then heading home around 9am (*before the crowds descend on the area*).

or

Car-pooling from Jannali High School is worthwhile as there is limited parking at Bondi. Arrive at Jannali at 4.15am because we must leave **at 4.30am sharp!** *Suggestion is if you get a lift, pay the driver \$5 towards their fuel ...*

PLEASE NOTE: Group Photo will be taken at main Sculpture at the point at Marks Park at 6.15am - Please join in the photo, thank you ...

Sculpture gives us a unique opportunity to photograph something different – a once a year opportunity to shoot subjects that are removed for good, only weeks after being erected.

Back dropped by the sea, these Sculptures (*with a bit of luck*), will be back lit with a pallet of striking vibrant colour, as sunrise approaches.

Each year this display attracts thousands of people, to see these sculptures, set in a beautiful, natural environment, between Bondi (Icebergs) and Tamara Beach.

For most of the people that venture to the coast to view this experience, will be spoilt by the parking problems, crowds, and the difficulty of getting a clear view of the sculptures (through the masses), not including the difficulty in trying to get uncluttered photos.

This is why, for this outing, (*our earliest start of the year*), we get there EARLY. Not to just avoid the crowds, but to get a close park & capture the coloured pre-dawn sky.

Note: The light starts to fill the sky from 5.20am, so don't miss your best photo opportunities, for 10 min extra sleep.

The idea is to photograph the Sculptures back lit by the pre-sunrise light. Once the sun breaks the horizon, it's time to recompose the shots of the Sculptures, so you're shooting **away** from the brightness of the sun.

PLEASE NOTE AGAIN: Group Photo will be taken at main Sculpture at the point at Marks Park at 6.15am - Please join in the photo, thank you ...



Even practice on a sunset (just before the last light in the sky disappears). If you are having problems or questions, please give me a call (0415 412 244) to discuss. It is better to do this BEFORE going to Sculpture by the Sea as there is only a 20 minute window for the best light. Check the 'How to Shoot' details below ...

ENHANCEMENT TASK for October

'You're Choice'

Submit two images – one 'As Shot' and one after you have Enhanced.

Please send to me by 'WeTransfer' (*PDF instructions at end of this UPDATE*) by Tuesday 31st October, so we can view at the next Society meeting, on the 2nd November, thank you.

TASK for OCTOBER

'Bokeh Circles'

Take (up to 5 images) of blurred (bokeh) highlights.

As you can see in the examples, when you take 'out-of-focus', bright contrasty highlights or lights, the result is circles of diffused light (called Bokeh).

Please send to me by 'WeTransfer' (*PDF instructions at end of this UPDATE*) by Tuesday 31st October, so we can view at the next Society meeting, on the 2nd November, thank you.



LIGHTROOM 'Develop Module Lesson' – Spaces still Available ...

- . Just to let you know I'm running **Lightroom Lessons** again on the **Develop Module**.
- . The one-off lesson covers all aspects of the Develop Module in Lightroom no matter what version you have.
- . The 3 ½ h lesson goes from 7pm – 10.30pm. There is 4 in a class, and the cost is \$60.
- . Bring 20 images on USB (*RAW would be better*) but jpg's are fine, so we can use your images to see what Lightroom can do with them.
- . PLEASE don't have too many files on USB, as I need to Virus check your USB, and if there is a lot of files, then it can take too long to scan. Don't bring a memory card or hard drive either.
- . There is no time for you to use your Lightroom on a laptop during this lesson – It just slows down the night for the others.
- . Text or give me a ring (0415 412 244) to book in a lesson. If you have friends or partner that you would like to do the lesson with, then check their availability before you contact me to book in. I will arrange others to do lesson with you.

Dates available (7pm)

NOVEMBER

Friday 3rd

Friday 10th

Tuesday 21st

Thursday 23rd

DECEMBER

Monday 4th

Friday 8th

Better if you can give a couple of options (preference is fine),

- . *I run the class at my home/office at 7 Eisenhower Place, Bonnet Bay.*
- . *My house is on the low side of the street, with a caravan outside.*
- . *Come down the driveway, then down the right-hand side of the house – My office is at the back.*

Society 'Walks for Life'

Next walks **Sunday 29th October**, 4.30pm at Taren Point.

The walk goes from Taren Point – Over the bridge to Sandringham and return (5km).

Great Society social activity without our cameras ... Why don't you join us ...

Give me a ring for details (0415 412 244)

NEXT Society Meeting - THURSDAY NIGHT (2nd November) 7.15pm

1st floor 'Club on East' (previously Sutherland United Services Club - SUS Club) opp. the car park - western side of Sutherland Station. 7.15pm start on 1st floor. There is also a well-lit car park at the rear of the club. Just drive up to the boom gate, tell them you're there for Photographic meeting, and they will let you in. At reception, tell them you're going to the Photographic meeting & they will sign you in ...

Please arrive around 7pm so that we can start at 7.15pm thank you ...

Bundeena House Society Xmas BBQ

Saturday 2nd December, 2017 (10am - 4pm)

This is a great way to socialise with fellow Society members. Bundeena House is a large, veranda surrounded historic building right on the beach at Bundeena (5 min walk from the Bundeena Ferry). In the last few years we have enjoyed this location for our Xmas BBQ, enjoying the opportunity to sit back and socialise with our friends in the Society. Quite a few people catch the ferry over from Cronulla.

It is a great chance for visitors and new members to come along and get to know other Society people.

Bring your meat, beer or wine if you wish. Plates, cutlery, salad, bread rolls, soft drinks provided. If some want to bring a sweets plate, it would be appreciated.

Barbara and Graham won't be able to run the day this year, as they have a local wedding to photograph, so we are going to be asking for help at the next Society meeting in November. Just a hand buying bread rolls, or cutting up the salads will be really appreciated. A couple of fellas to help with the BBQ would also be appreciated, thank you.



BLACKBOARD of Outings & Events

<http://sutherlandshirephotography.com.au/blackboard/>

OCTOBER

28th Sat	SOCIETY OUTING 'Sculpture by the Sea'
4.15am	Jannali High School (car pooling)
5.15am	Marks Park, Bondi
<i>29th Sun</i>	<i>Taren Point Social Walk (5km)</i>
31st Tue	Wet alternative for 'Sculpture by the Sea' (if cancelled Sat)

NOVEMBER

2nd Thu	7.15pm	SOCIETY MEETING - Club on East (SUS Club) 1st floor
<i>5th Sun</i>	<i>4.30pm</i>	<i>Taren Point Social Walk (5km)</i>
12th Sun	8am	SOCIETY OUTING (t.b.a.)
<i>12th Sun</i>	<i>4.30pm</i>	<i>Taren Point Social Walk (5km)</i>
<i>19th Sun</i>	<i>4.30pm</i>	<i>Taren Point Social Walk (5km)</i>
<i>26th Sun</i>	<i>4.30pm</i>	<i>Taren Point Social Walk (5km)</i>
30th Thu	7.15pm	SOCIETY MEETING (option #1) - Club on East (SUS Club) 1st floor

*** Final Meeting date will be confirmed with Club 1 week before, due to Club hire commitments re Xmas**

DECEMBER

2nd Sat	10-4	SOCIETY XMAS BBQ (Bundeena)
<i>3rd Sun</i>	<i>4.30pm</i>	<i>Taren Point Social Walk (5km)</i>
7th Thu	7.15pm	SOCIETY MEETING (option #2) - Club on East (SUS Club) 1st floor
<i>10th Sun</i>	<i>4.30pm</i>	<i>Taren Point Social Walk (5km)</i>
<i>17th Sun</i>	<i>8am</i>	SOCIETY OUTING (t.b.a.)
<i>17th Sun</i>	<i>4.30pm</i>	<i>Taren Point Social Walk (5km)</i>

Xmas break ...

JANUARY

21st Sun	8am	SOCIETY OUTING (t.b.a.)
<i>21st Sun</i>	<i>4.30pm</i>	<i>Taren Point Social Walk (5km)</i>

FEBRUARY

1st Thu	7.15pm	SOCIETY MEETING - Club on East (SUS Club) 1st floor
---------------------------	---------------	---

** Walks & Rides start at Woodlands Road, Taren Point (opp. Smith Street).*

- Rides go to Wanda along mostly bike track (15km), and the Walks go to Sans Souci (over bridge) 5km

- Message me if you're wanting to come, as early as possible (0415 412 244)

- If I cancel (re weather), I will message you and let you know ...

NEXT MEETING 2nd November, 2017 (7.15pm)

Participating in the ‘Shire Amateur Photographers’ Society’ (SAPS) Activities

- Membership (remainder of 2017) \$10 (calendar year)
- Membership (2018) \$30 (calendar year) increasing due to running costs, sorry
- Meeting attendance \$ 5 (you can attend 2 meetings before joining)
- Society Outings/Outside Activities – Society must have a Risk Warning, Release and Waiver Form signed
- Unofficial Outings/Activities: These events are not formally run by the Society. They are activities that some of the Society members, friends, and families may join in together as private activities. These events may be promoted though on the SAPS Facebook site for anybody interested
- A Risk Warning, Release and Waiver form must be filled in if participating in a Society activity and will remain ongoing as long as you participate in Society activities.

Participating in ‘Sutherland Shire Photography’ (SSP) Activities

- Night & Day Mystery Tours and Trips Away require you to sign a Risk Warning, Release and Waiver Form
 - Trips Away (Society Members only) Active members take precedence, but family and friends can go on waiting list, so that if additional numbers are required (closer to departure), they are welcome to fill the gaps.
- Note: All people going on Trips Away must be members of the Society.

www.sutherlandshirephotography.com.au

0415 412 244

gphoto@optusnet.com.au



Thanks to Tony and the staff of Digi Direct (Miranda) for their support of our Photographic Society. For all your photographic requirements, see them – Bottom level, Shop 1098, Westfield Miranda (9589 5700)

WeTransfer Instructions



WeTransfer  *Click on link*
<https://www.wetransfer.com/> ▼

WeTransfer is a free service to send big or small files from A to B.

WeTransfer Plus

Get more out of WeTransfer with Plus. For the people who love ...

Menu

We're glad you're here! Try the free service, or find some ...

How it works

It's simple, secure and free of charge. ... How it works ...

[More results from wetransfer.com »](#)

About WeTransfer.com

We are sure you have seen those beautiful wallpapers on ...

Change language

Choose your language. Select language. English. Select ...

WeTransfer Mobile

WeTransfer Mobile. Boost your productivity and preserve ...

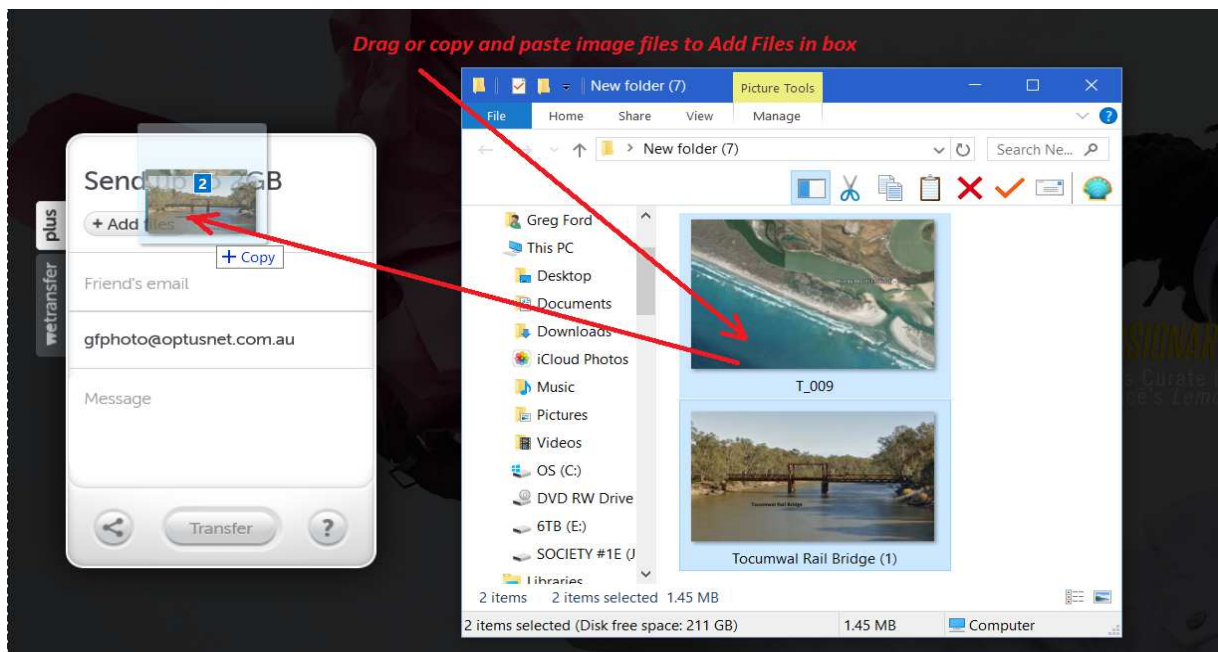
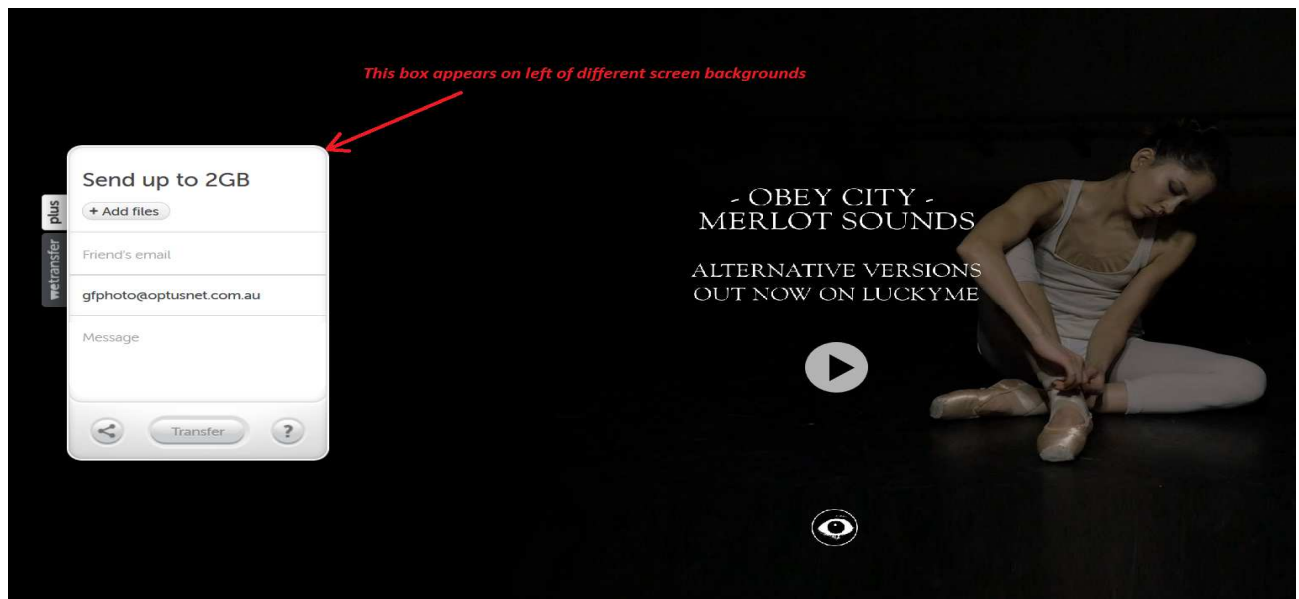

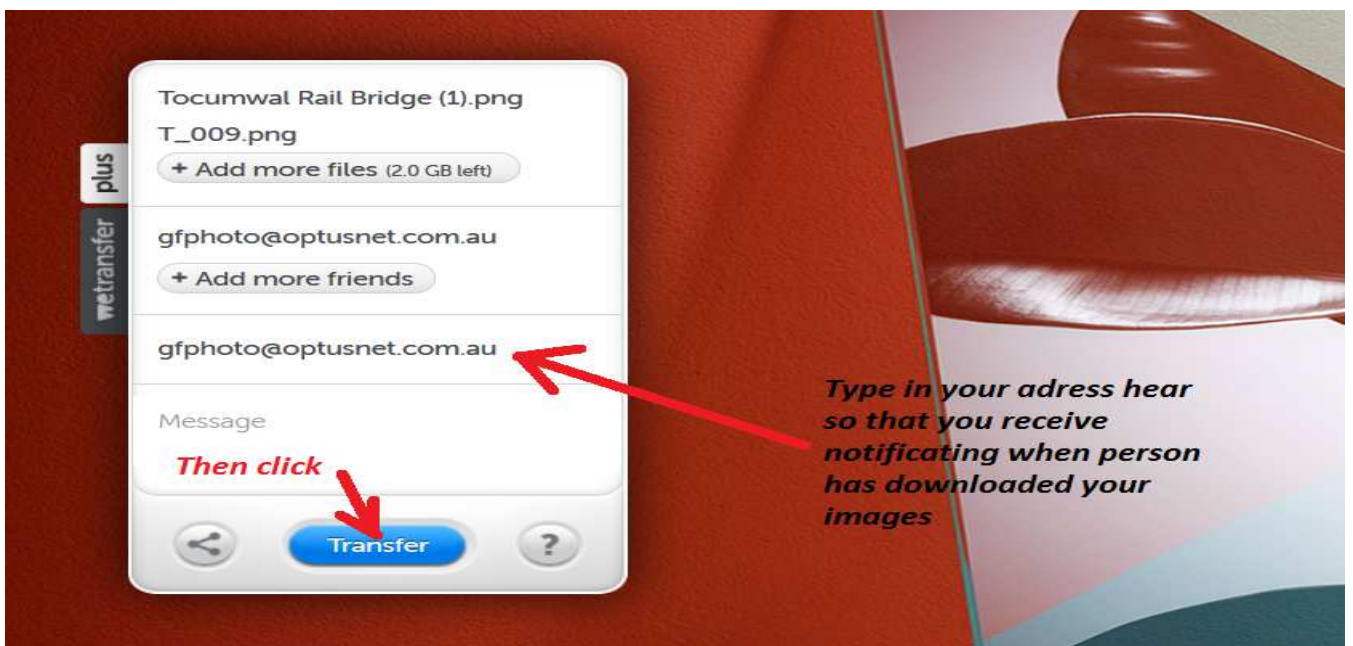
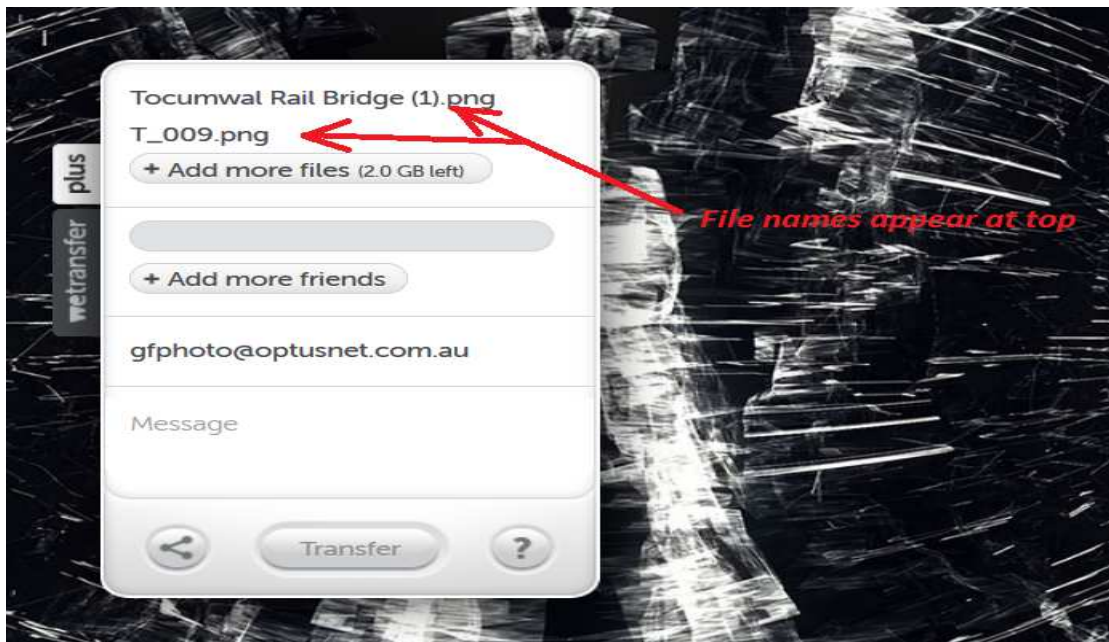

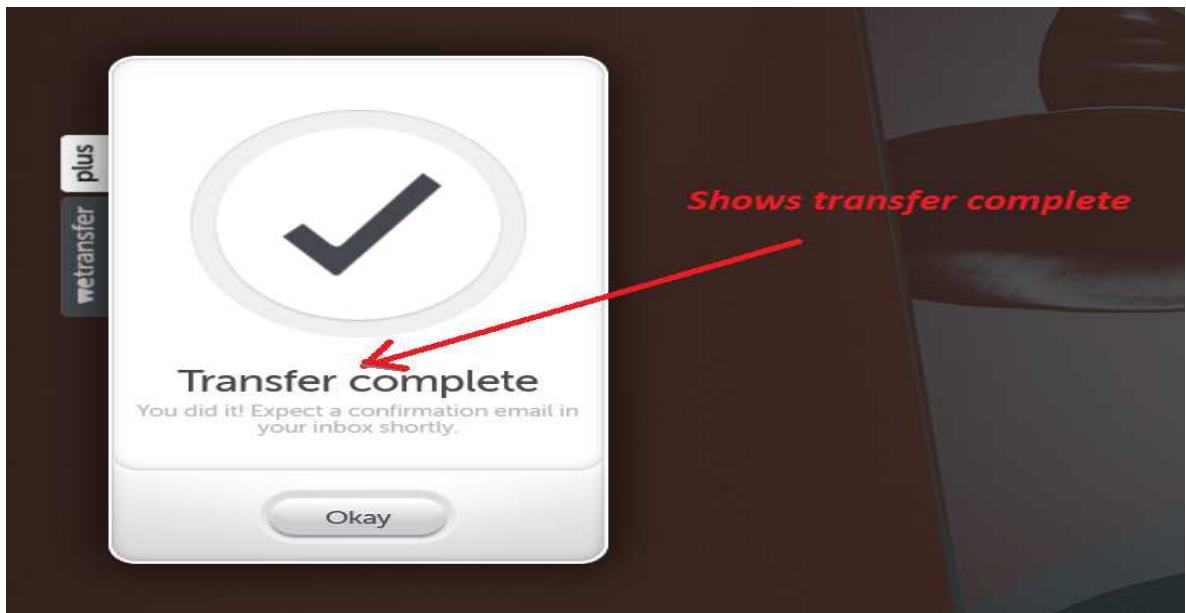
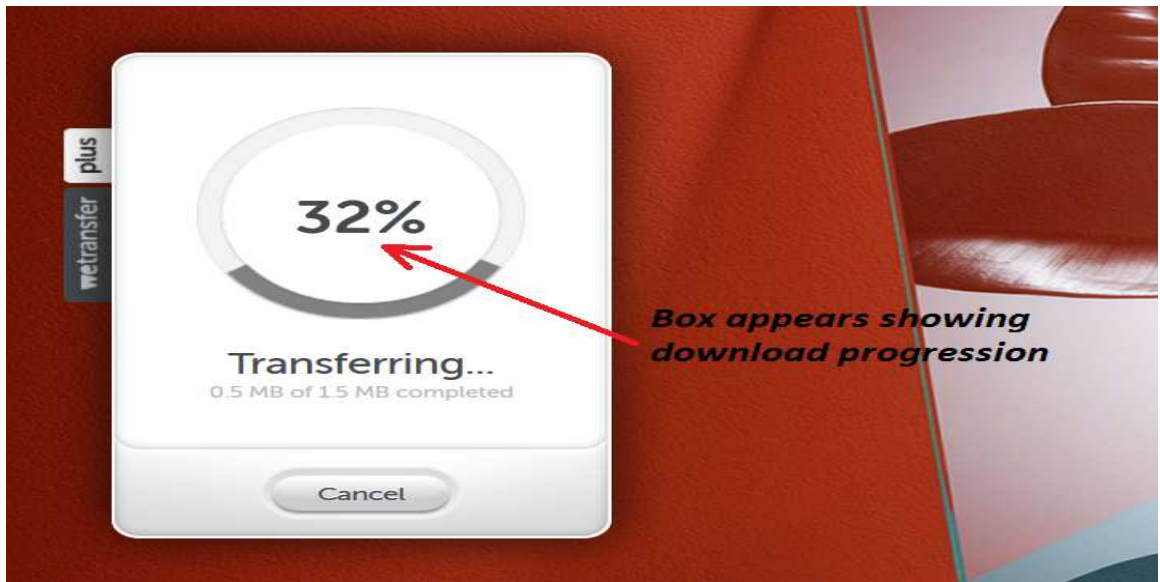

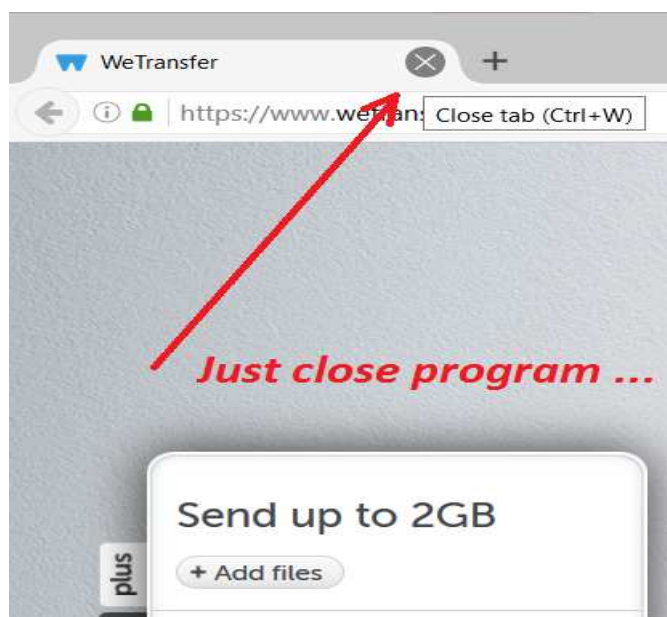

Files successfully sent to gfphoto@optusnet.com.au

As soon as a recipient has downloaded your file, you will receive a confirmation email.

This box opens to show recipient has downloaded files ...

Recipients
gfphoto@optusnet.com.au

Files (1.45 MB total)
Tocumwal Rail Bridge (1).png
T_009.png

Will be deleted on
8 June, 2016

Download link
<https://we.tl/S5LSV76okd>

